

1/4" SERIES FRAMELESS NEO-ANGLE SHOWER ENCLOSURE

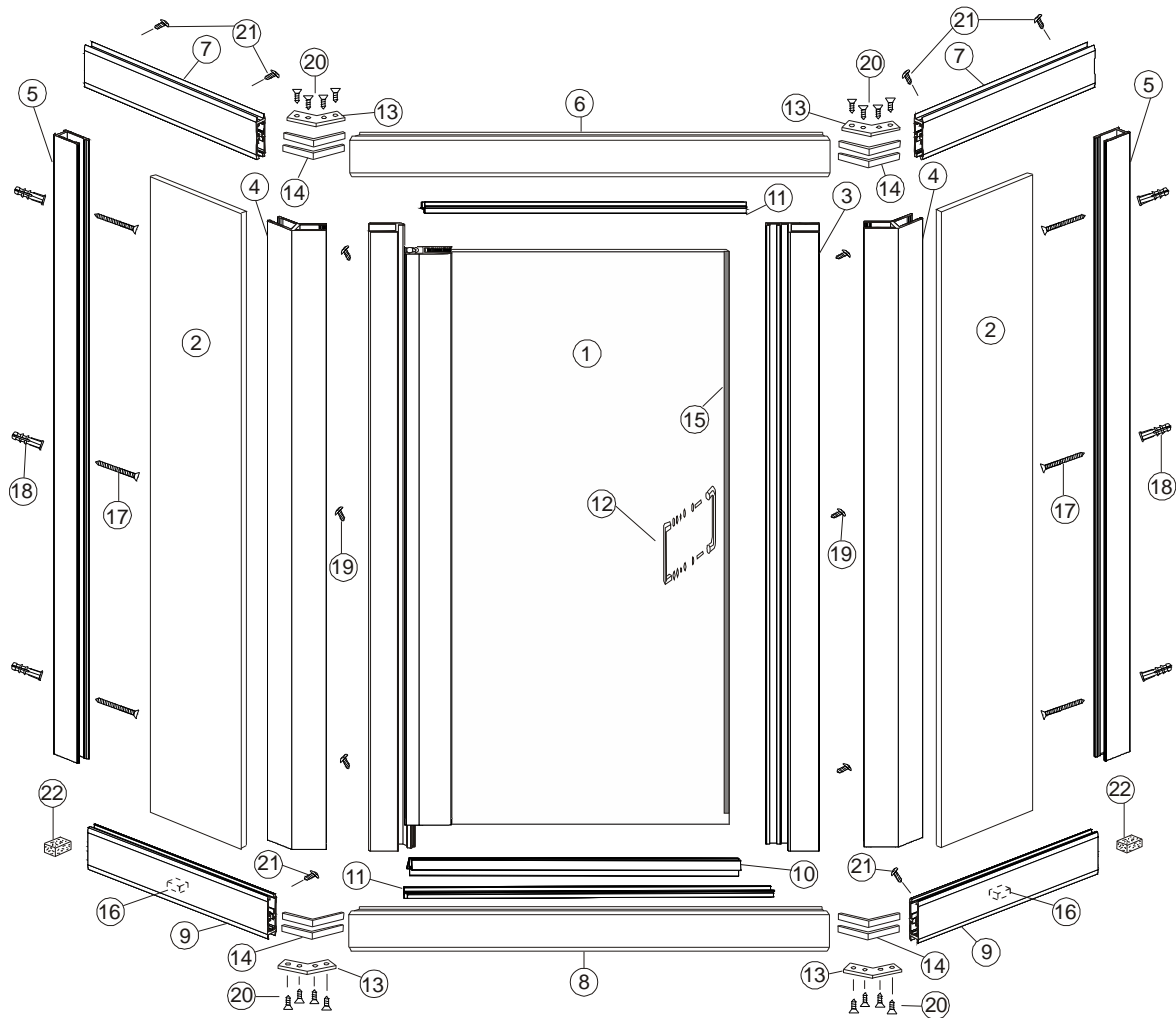

HARDWARE PACK: QTY:

CAT#: PART LIST: LENGTH: QTY:

①	DOOR ASSEMBLY		1
②	PANELS		2
③	1193 STRIKE JAMB & Mag.		1
④	1175 135° CORNER POST		2
⑤	1268 WALL CHANNEL		2
⑥	1171 DOOR STALL HEADER		1
⑦	1171 PANEL STALL HEADER		2
⑧	1171 DOOR STALL CURB		1
⑨	1271 PANEL STALL CURB		2
⑩	4062 1/4" DRIP RAIL		1
⑪	1072 CURB FILLER		2

⑫	6" HANDLE TO HANDLE	1
⑬	2018 HEADER PLATE	4
⑭	2017 HEADER CLIP	8
⑮	4102 ADHESIVE MAGNET	1
⑯	2203 SETTING BLOCKS	4
⑰	2101 #8X1-1/2" FHPHSMS	6
⑱	2217 WALL ANCHORS	6
⑲	2110 #8X1/2" PHPH TEK	6
⑳	2103 #6X3/8" FHPHSMS	16
㉑	2102 #6X3/8" PHPHSMS	6
㉒	2204 FOAM PLUG	2
㉓	4025 VS-13 THIN VINYL	8
㉔	4026 VS-14 THICK VINYL	8

TOOLS REQUIRED FOR P/J/P14 REV INSTALLATION

- | | |
|---|--|
| 1. Caulking gun & approved silicone sealant | 6. 3/16" drill bit for plastic anchors |
| 2. Rubber Mallet | 7. 3/16" carbide drill bit for tile |
| 3. Hacksaw | 8. C-clamp or strong spring clamp |
| 4. Phillips Screwdriver | 9. Drill & 1/8" Drill Bit |
| 5. Mill file to smooth cut edges or radius | 10. Level |

1. The curb sections may have already been cut to size at the factory. If not, measure the centerline distance of the door and return panels on the threshold and add 3/16" to each measurement. Measure from the longest point of the miter and cut the square end of the curb. On the door section you must duplicate the factory miter at the other end. Insert one foam plug into each square cut end of the return section. Recess about 1/8" and fill recess with sealant. Assemble curb sections with two curb clips and one plate, position curb sections onto the base. Seal the mitered corners with sealant and readjust alignment if necessary. Insert a setting block into the curb where the glass panels will set, glass should never set on the metal curb.

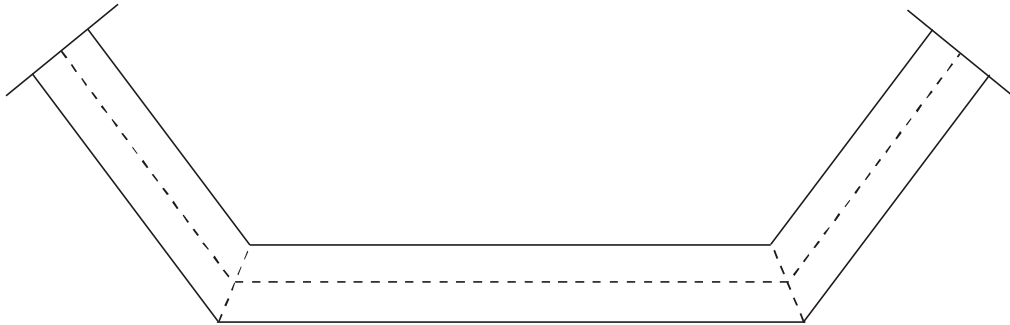

2. Place the wall channel into the curb, against the wall and plumb with a level. Mark the mounting holes and remove the channel. Drill a 3/16" hole and insert the wall anchors. Use a carbide bit for tile or masonry applications. Secure the channel to the wall with a #8x1-1/2" flat head screw and repeat for the other wall.

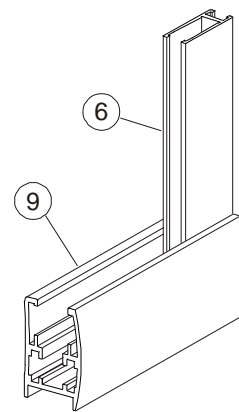

3. Insert the correct glass panel for the return into the wall channel and the curb, making sure that it is on setting blocks. If patterned glass or frosted glass is used, make sure that the rough side faces out. Insert the corner post over the edge of the glass and into the curb. Hold the corner post and glass in place temporarily with the thin vinyl on each side of the glass into both of the channels at the top. Do not cut the vinyl at this time. Repeat this procedure for the second panel.

4. Using a level, plumb each of the 135° corner posts. Measure from the outside of the corner post to the wall in each direction. Add 1/16" to each dimension. Cut the appropriate header for each return panel measuring from the longest point and cutting from the square end. Measure from the outside of each corner post for the door header, and add 1/8" to that dimension. Cut the door header to that dimension and duplicate the factory miter on the other end. Assemble the header sections with 4 header clips and 2 header plates. Making sure that the miters are tight mark the holes in the plate onto the top of the header. Drill the holes with a 1/8" drill bit. Secure the plate onto the headers with 8 #6x3/8" flat head screws.

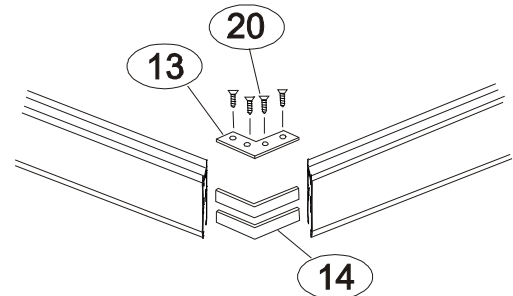

5. Set headers in place over the top of the vertical posts. From the inside of the shower, attach the headers by drilling through the headers into the verticals with a 1/8" drill bit. Make sure to avoid the glass panels while drilling. The bottom of the 135° posts should be secured in the same manner.

6. Center the return panel glass between the wall channel and the corner post, and insert the thin vinyl between the glass and vertical metal channels on both sides. Insert the thick vinyl between the glass and the header and between the glass and the curb, inside and out. Repeat for the other panel.

7. Place the strike jamb (#3) over the vertical post of your choice, do not secure at this time. Orient the door so that it can open outwards and slide it over the remaining post. Adjust the door and strike so that they are equally off of their respective posts. Adjust the hinge jamb so that the top of the door is parallel with the bottom of the header. From the inside of the shower, drill the top hole through the hinge jamb into the vertical post with a 1/8" drill bit. Secure the jamb with a #6x3/8" pan head screw. Recheck door alignment and repeat the procedure for the middle and bottom screws.

Assemble the handle through the holes in the glass with the bushings and shims provided.

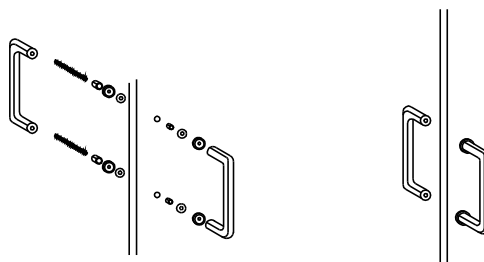

8. Clean the door glass on the inside with a good quality glass cleanser, the adhesion of the magnet will depend on how clean the glass is. Measure the door glass from the top to the bottom and cut the magnet to fit, making sure to have square cuts on the ends. Peel the backing off of the magnet and apply to the glass on the inside of the door, making sure to keep the magnet straight and even along the edge. The adhesive will attain maximum strength in 72 hours, but the door may be used during this time.

9. Adjust the strike jamb to the door assembly. Center the magnets on each other. If the magnets repel each other, remove the strike jamb, and slide the magnet out, turn end for end and insert back into the jamb. Replace the jamb and adjust to work with the magnet on the door. Once adjusted correctly, from the inside of the shower, drill the top hole into the strike jamb and vertical post with a 1/8" drill bit. Secure the jamb with a #6x3/8" pan head screw. Recheck alignment and repeat the procedure for the middle and bottom screws.

10. With the door in closed position, measure between the hinge jamb and strike jamb at the top of the stall curb. Cut one curb filler (#13) to this length. Snap the filler into place in the curb with the vertical water dam to the outside of the shower. Seal each end with sealant. Repeat this step for the header filler. The top filler does not require sealant.

11. To install the drip rail on the bottom of the door, measure the glass at the bottom of the door on the inside between the magnet and hinge jamb. The slanted portion of the drip rail goes on the inside of the shower. If necessary notch the portion of the dripshield so that it will fit under the hinge rail. Test fit and make sure that the drip rail does not interfere with the magnet. Place a few drops of silicone inside of the channel of the drip rail and press upwards onto the bottom of the door.

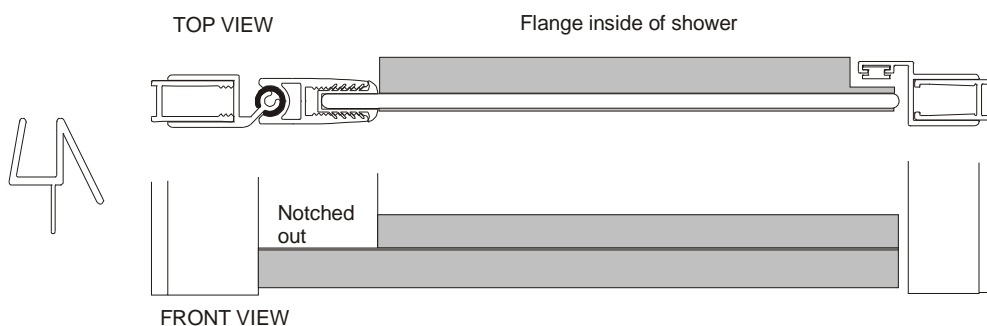

12. Run a continuous bead of silicone across the outside of the shower unit where the metal meets the walls and threshold.

NOTE; For installation and technical support please reference the shipping document, the box that the product was shipped in or call the store where you purchased this product from.